

ALL STAINLESS LIMITED

21 Camford Way
Sundon Park
Luton, Beds
LU3 3AN

Telephone: 01582 584075

Facsimile: 01582 585234

E-mail: info@allstainlessltd.co.uk

INFORMATION SHEET

NOMINAL BORE FITTINGS

NOMINAL BORE FITTINGS

The range of Nominal Bore fittings listed below are available from stock in sizes ½" N.B. to 12" N.B. in both 304L and 316L. Larger sizes available on special delivery. Separate information sheets covering Nominal Bore Pipe, BSP Fittings and Flanges are also available. Please contact our sales desk for details.

90° Elbow Long radius

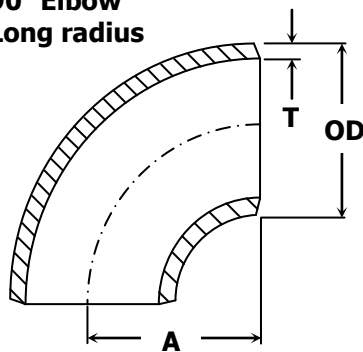

N.B. Pipe Size	OD mm	A mm	Wall (T) mm		
			Sch 5	Sch 10	Sch 40
½"	21.34	38.1	1.65	2.11	2.77
¾"	26.67	28.7	1.65	2.11	2.87
1"	33.4	38.1	1.65	2.77	3.38
1 ½"	48.26	57.15	1.65	2.77	3.68
2"	60.33	76.2	1.65	2.77	3.91
2 ½"	73.03	95.25	2.11	3.05	5.16
3"	88.9	114.3	2.11	3.05	5.49
4"	114.3	152.4	2.11	3.05	6.02
6"	168.28	228.6	2.77	3.40	7.11
8"	219.08	304.8	2.77	3.76	8.18
10"	273.05	381.0	3.40	4.19	9.27
12"	328.9	457.2	3.96	4.57	9.27
14"	355.6	533.4	3.96	4.78	9.27
16"	406.4	609.6	4.19	4.78	9.27
18"	457.2	685.8	4.19	4.78	9.27
20"	508	762.0	4.78	5.54	9.27
24"	609.6	914.4	5.54	6.35	9.27

45° Elbow Long radius

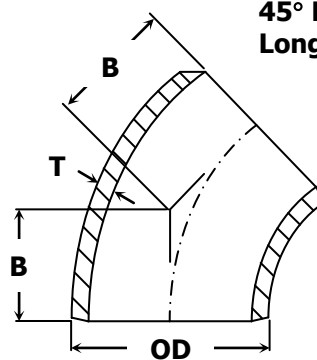

N.B. Pipe Size	OD mm	B mm	Wall (T) mm		
			Sch 5	Sch 10	Sch 40
½"	21.34	16.00	1.65	2.11	2.77
¾"	26.67	11.18	1.65	2.11	2.87
1"	33.4	22.35	1.65	2.77	3.38
1 ½"	48.26	28.70	1.65	2.77	3.68
2"	60.33	35.05	1.65	2.77	3.91
2 ½"	73.03	44.45	2.11	3.05	5.16
3"	88.9	50.08	2.11	3.05	5.49
4"	114.3	63.50	2.11	3.05	6.02
6"	168.3	95.25	2.77	3.40	7.11
8"	219.1	127.0	2.77	3.76	8.18
10"	273.0	158.8	3.40	4.19	9.27
12"	328.9	190.5	3.96	4.57	9.27
14"	355.6	222.3	3.96	4.78	9.27
16"	406.4	254.0	4.19	4.78	9.27
18"	457.2	285.8	4.19	4.78	9.27
20"	508	317.5	4.78	5.54	9.27
24"	609.6	381.0	5.54	6.35	9.27

Straight Tees

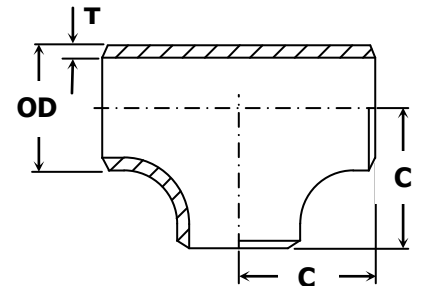

N.B. Pipe Size	OD mm	C mm	Wall (T) mm		
			Sch 5	Sch 10	Sch 40
½"	21.34	25.4	1.65	2.11	2.77
¾"	26.67	28.7	1.65	2.11	2.87
1"	33.4	38.1	1.65	2.77	3.38
1 ½"	48.26	57.2	1.65	2.77	3.68
2"	60.33	63.5	1.65	2.77	3.91
2 ½"	73.03	76.2	2.11	3.05	5.16
3"	88.9	85.6	2.11	3.05	5.49
4"	114.3	104.9	2.11	3.05	6.02
6"	168.28	143.0	2.77	3.40	7.11
8"	219.08	177.8	2.77	3.76	8.18
10"	273.05	215.9	3.40	4.19	9.27
12"	328.9	254.0	3.96	4.57	9.27
14"	355.6	279.4	3.96	4.78	9.27
16"	406.4	304.8	4.19	4.78	9.27
18"	457.2	342.9	4.19	4.78	9.27
20"	508	381.0	4.78	5.54	9.27
24"	609.6	431.8	5.54	6.35	9.27