

ALL STAINLESS LIMITED

21 CAMFORD WAY
SUNDON PARK
LUTON, BEDS
LU3 3AN

TELEPHONE: 01582 584075
FACSIMILE: 01582 585234
E-MAIL: INFO@ALLSTAINLESSLTD.CO.UK

**INFORMATION
SHEET**

NPT FITTINGS

NPT FITTINGS

We stock a full range of NPT fittings, which are available in both 3000lb and 6000lb. The dimensions shown are for the 3000lb range generally to BS3799.

For further information contact our sales desk

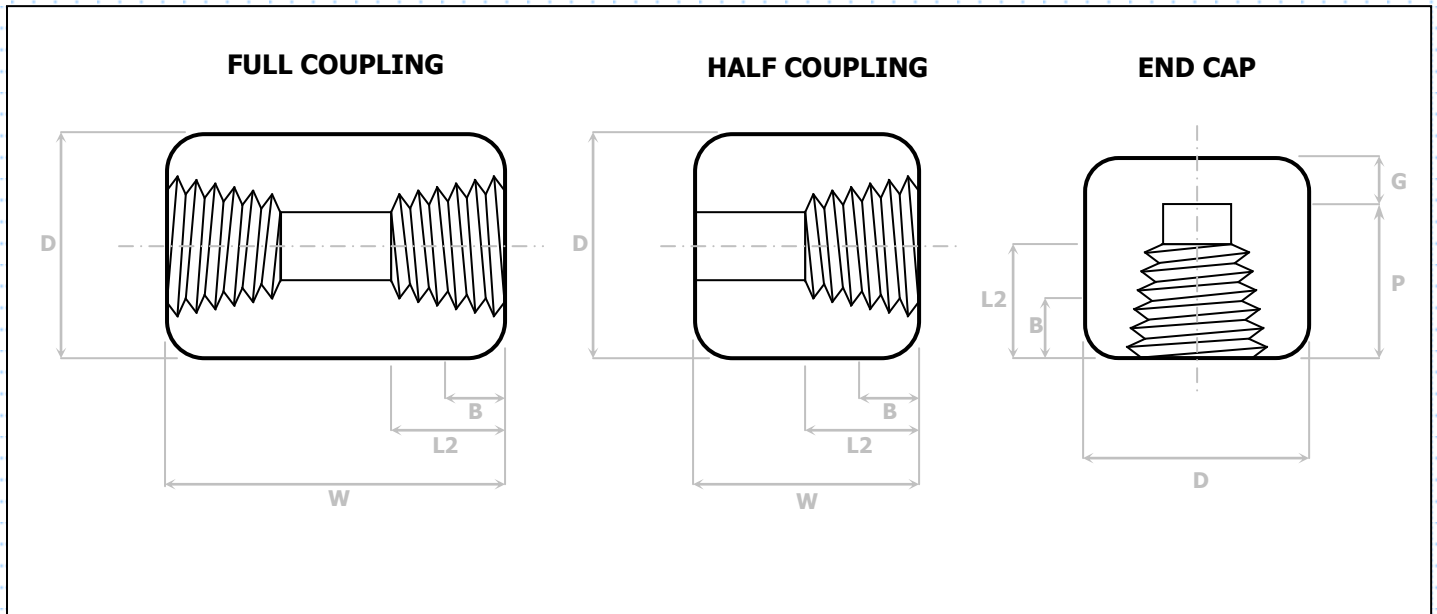

NPS	End to End Couplings	End to End Caps	OD	End Wall Thickness	Length of Thread	
	W	P	D	G	B	L2
	mm	mm	mm	mm	mm	mm
1/8"	32	19	16	5.0	6.5	6.5
1/4"	35	25	19	5.0	8.0	10.0
3/8"	38	25	22	5.0	9.0	10.5
1/2"	48	32	29	6.5	11.0	13.5
3/4"	51	37	35	6.5	12.5	14.0
1"	60	41	44	9.5	14.5	17.5
1 1/4"	67	44	57	9.5	17.0	18.0
1 1/2"	79	44	64	11.0	18.0	18.5
2"	86	48	76	12.5	19.0	19.0
2 1/2"	92	60	92	16.0	23.5	29.0
3"	108	65	108	19.0	26.0	30.5
4"	121	68	140	22.0	27.5	33.0

Note:

- Dimensions and tolerances shown are as specified in ASME/ANSI B16.11-1991. These are substantially with BS3799:1974. Exceptions are indicated in the following notes.
- BS3799 does not cover class 6000lb caps with NPS > 2
- BS3799 dimensions G and L2 vary slightly from the ANSI values quoted. Dimension B is not specified in BS3799.
- Dimension B is the length of perfect thread. L2 is the effective length of thread based on ANSI/ASME B1.20.1 (NTP).

90° ELBOW

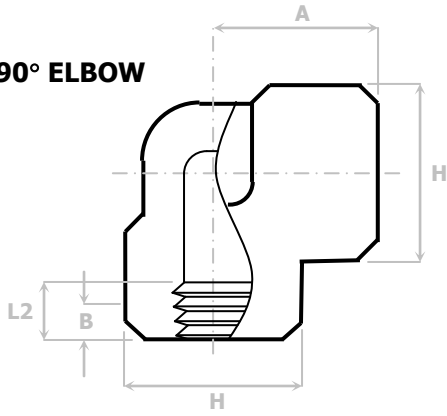

EQUAL TEE

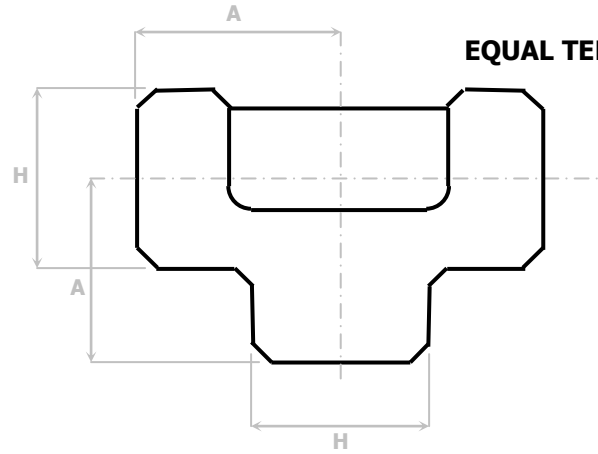

EQUAL CROSS

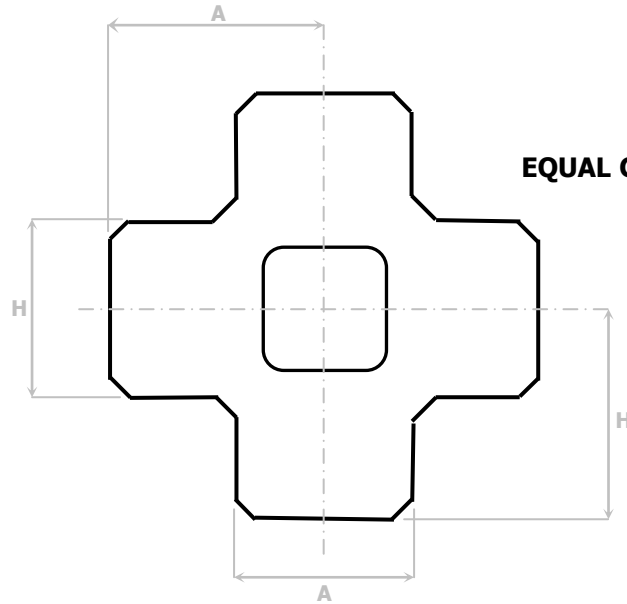

NPS	Centre to End	OD of Band, Min	Wall Thickness, Min	Length of Thread, Min	
	A	H	G	B	L2
	mm	mm	mm	mm	Mm
1/8"	21	22	3.0	6.5	6.5
1/4"	25	25	3.5	8.0	10.0
3/8"	29	33	3.5	9.0	10.5
1/2"	33	38	4.0	11.0	13.5
3/4"	38	46	4.5	12.5	14.0
1"	44	56	5.0	14.5	17.5
1 1/4"	51	62	5.5	17.0	18.0
1 1/2"	60	75	5.5	18.0	18.5
2"	64	84	7.0	19.0	19.0
2 1/2"	83	102	7.5	23.5	29.0
3"	95	121	9.0	26.0	30.5
4"	114	152	11.0	27.5	33.0

Note:

- Dimensions and tolerances shown are as specified in ASME/ANSI B16.11-1991. These are substantially with BS3799:1974. Exceptions are indicated in the following notes.
- BS3799 does not cover class 2000Lb fittings and class 6000Lb fittings with NPS < 1/2".
- BS3799 dimensions G and L2 vary slightly from the ANSI values quoted. Dimension B is not specified in BS3799.
- Dimension B is the length of perfect thread. L2 is the effective length of thread based on ANSI/ASME B1.20.1 (NTP).